

TABUK CITY  
 LAND USE & ZONING

LINE & GRADE

ARCHITECTURAL

STRUCTURAL

PLUMBING

ELECTRICAL

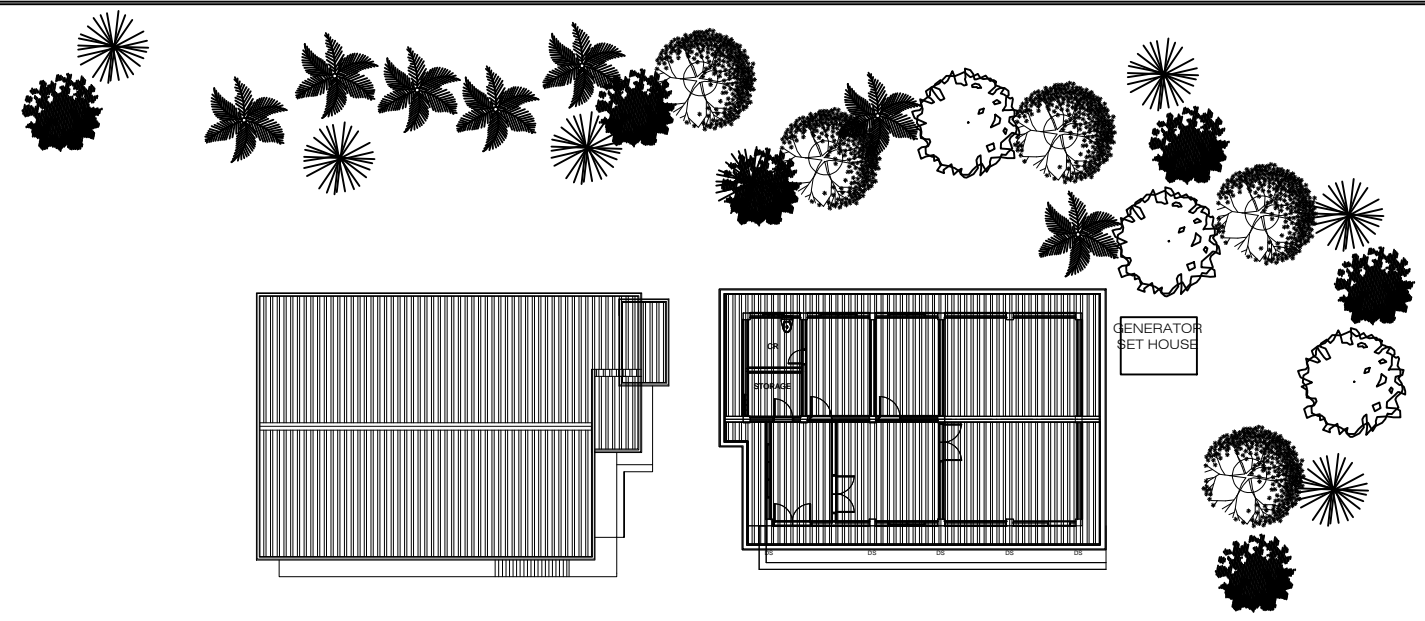

MINOR ROAD

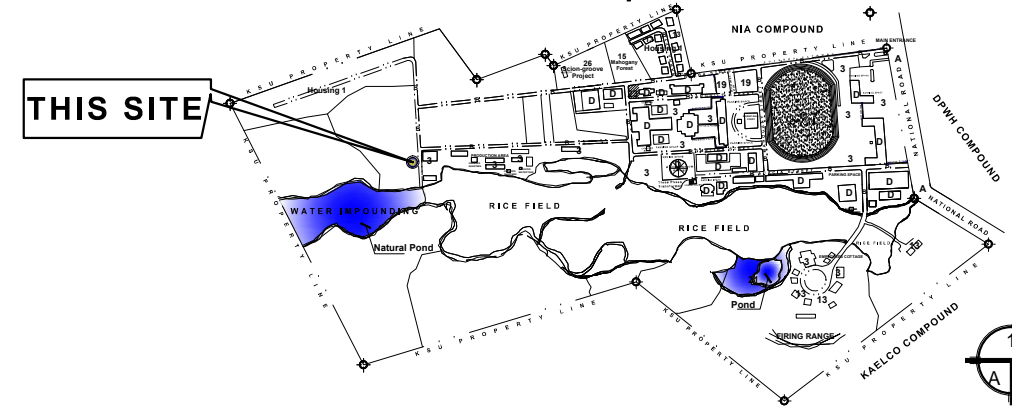

 <p><b>KALINGA STATE UNIVERSITY</b>  <b>INFRASTRUCTURE DEPARTMENT</b>                  BULANAO, TABUK CITY, KALINGA</p>	PREPARED BY	CADD BY	CHECKED AND REVIEWED BY	CONCURRED BY	PROJECT TITLE	RECOMMENDING APPROVAL:	APPROVED BY:	SHEET CONTENTS	SHEET NO.
	KSU INFRASTRUCTURE UNIT	OWNERSHIP OF DOCUMENTS	Arch. JENIE L. ABAD CHAIRMAN FOR PLANNING	JOVITA E. SAGUIBO, Ph.D VP FOR RESEARCH DEVELOPMENT & EXTENSION	<b>GENERATOR SET HOUSE</b> <small>UPGRADING OF EXISTING GENERATOR (Agencies Proposed) FACILITY AT KALINGA STATE UNIVERSITY</small>	Engr. LOPE T. BUEN, Ph.D DIRECTOR FOR PLANNING AND STRATEGY	EDUARDO T. BAGTANG, CPA,DBM KSU PRESIDENT	AS SHOWN	1
	REG. NO.	RA 9266- SECTION 33	Address:	Address:	Project Location:	Address:	Address:		OF
	FTR. NO.	<small>THESE DRAWINGS, AS INSTRUMENT OF PROFESSIONAL SERVICE IS A PROPERTY OF THE ARCHITECT AND AS SUCH CANNOT BE REPRODUCED, COPIED IN PART OR IN WHOLE WITHOUT PROPER AUTHORIZATION.</small>	Bulanao, Tabuk City, Kalinga	Bulanao, Tabuk City, Kalinga	KSU Bulanao, Tabuk City, Kalinga	Bulanao, Tabuk City, Kalinga	Bulanao, Tabuk City, Kalinga		9