

VICINITY MAP
SCALE 1:100 m.

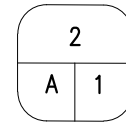

BUILDING FOOTPRINT
SCALE 1:100 m.

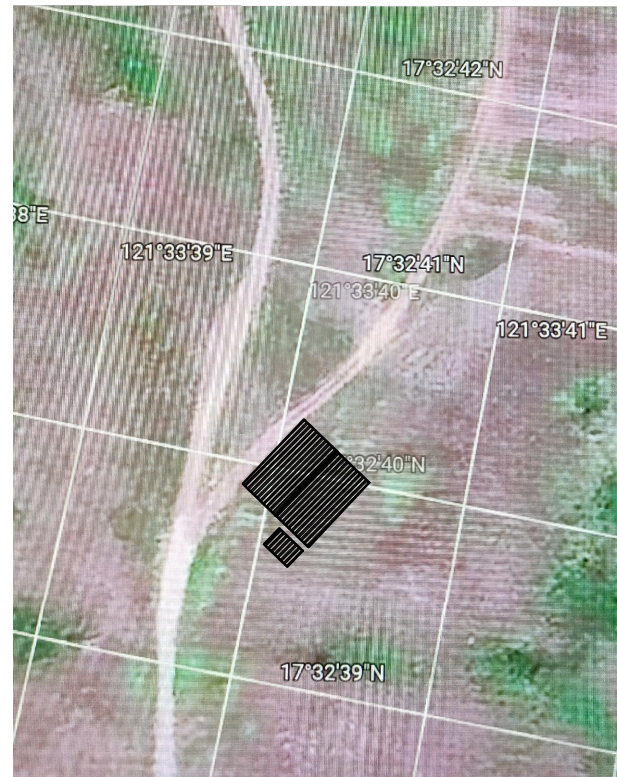
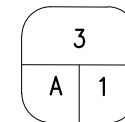

PERSPECTIVE
SCALE 1:100 m.

CONTENTS

ARCHITECTURAL	
A-1	VICINITY MAP, BUILDING FOOTPRINT AND PERSPECTIVE
A-2	FLOOR PLAN (MAIN BUILDING, AI LAB AND GRAZING/FORAGE AREA)
A-3	FRONT AND REAR ELEVATION (MAIN BUILDING)
A-4	LEFT AND RIGHT ELEVATION (MAIN BUILDING)
A-5	FRONT, REAR, LEFT AND RIGHT ELEVATION (AI LAB)
A-6	FLOOR FINISH (ALL AREAS)
A-7	SCHEDULE OF DOORS AND WINDOWS
A-8	RAILING DETAIL AND ELEVATION, TROUGH DETAILS, FENCING, RAMP AND STAIR DETAILS, COUNTER TOP DETAILS
STRUCTURAL	
S-1	FOUNDATION PLAN
S-2	COLUMN FOOTING DETAILS, PLANS AND SECTIONS WALL FOOTING DETAILS, AND COLUMN-FOOTING SCHEDULE
S-3	FLOOR FRAMING PLAN (MAIN BUILDING)
S-4	AI LAB FRAMING PLAN, BEAM TYPICAL DETAIL AND SCHEDULE
S-5	ROOF FRAMING PLAN
S-6	TRUSS DIAGRAM AND DETAIL (TRUSS A & B)
PLUMBING/SANITARY	
P-1	SANITARY AND COLD WATER LINE LAYOUT
P-2	SANITARY AND COLD WATER LINE ISOMETRIC LAYOUT
P-3	DOWNSPOUT LAYOUT
P-4	LAVATORY, FLOOR DRAIN, WATER CLOSET AND CLEANOUT DETAILS
ELECTRICAL	
E-1	LIGHTING LAYOUT
E-2	POWER LAYOUT
E-3	RISER DIAGRAM, SCHEDULE OF LOADS, LEGENDS AND SYMBOLS AND GENERAL NOTES AND SPECIFICATIONS



KALINGA STATE UNIVERSITY
INFRASTRUCTURE DEPARTMENT
BULANAO, TABUK CITY, KALINGA

PREPARED BY:	
REG. NO.	
PTR. NO.	
DATE	
PLACE	
CADD BY:	SMB
CHECKED BY:	Arch. JENIE L. ABAD CHAIRMAN FOR PLANNING
REG. NO.	
PTR. NO.	
DATE	
PLACE	
CONCURRED BY:	DR. RUBY ORANGE AGYAO END USER
	REX M. DUCLAYAN END USER

PROJECT TITLE:	CONSTRUCTION OF KSU RIZAL GOAT FARM	
Project Location:	Rizal, Kalinga	
RECOMMENDING APPROVAL:	Engr. LOPE T. BUEN, Ph.D DIRECTOR FOR PLANNING AND STRATEGY Address: Bulanao, Tabuk City, Kalinga	
APPROVED BY:	EDUARDO T. BAGTANG, CPA, DBM KSU PRESIDENT Address: Bulanao, Tabuk City, Kalinga	
SHEET CONTENTS:	AS SHOWN	
SHEET NUMBER:	A-1	PAGE NUMBER: 1

OWNERSHIP OF DOCUMENTS

RA 9266- SECTION 33
THESE DRAWINGS, AS INSTRUMENT OF PROFESSIONAL SERVICE IS A PROPERTY OF THE ARCHITECT AND AS SUCH CANNOT BE REPRODUCED, COPIED IN PART OR IN WHOLE WITHOUT PROPER AUTHORIZATION.