



FARM COORDINATES:

1. 17.54138889 N
121.56250000 E
2. 17.54200 N
121.560722 E
3. 17.546083 N
121.559917 E
4. 17.545972 N
121.563917 E

DISTANCE FROM POINT TO POINT:

- 1-2: 200.38m
- 2-3: 461.96m
- 3-4: 424.27m
- 4-1: 531.13m

LEGENDS:

-  EXISTING CONCRETE POSTS: 350
-  NEW CONCRETE POSTS: 190

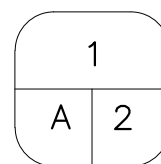
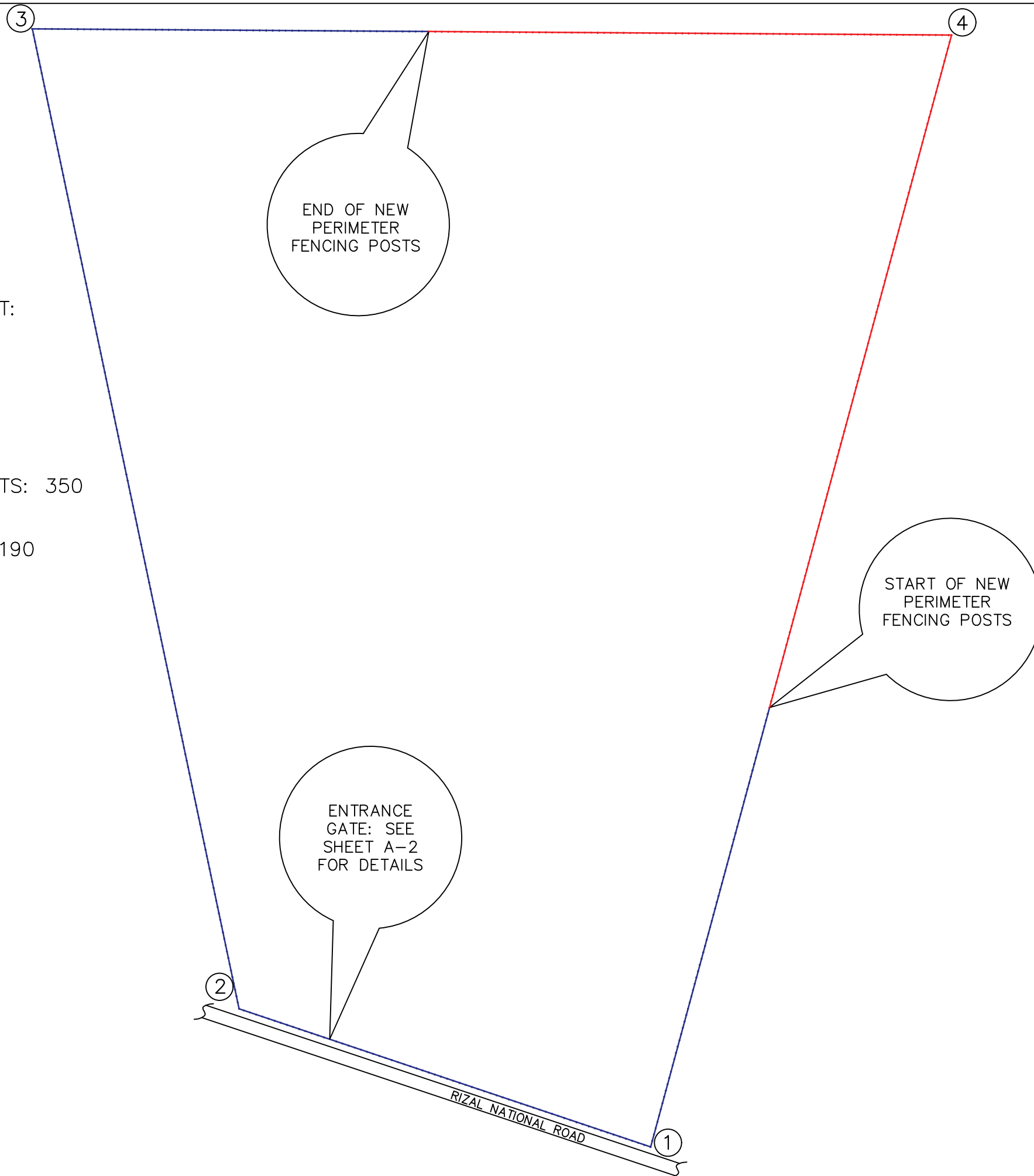

SITE PLAN: MULBERRY FARM
SCALE NTS

**KALINGA STATE UNIVERSITY
INFRASTRUCTURE DEPARTMENT**
BULANAO, TABUK CITY, KALINGA

PREPARED BY:

KSU INFRASTRUCTURE UNIT

REG. NO.

PTR. NO.

DATE

PLACE

CADD BY:

KSU INFRASTRUCTURE UNIT

CHECKED BY:

Arch. JENIE L. ABAD
CHAIRMAN FOR PLANNING

REG. NO.

PTR. NO.

DATE

PLACE

CONCURRED BY:

VICTORINO C. BAYED
CAMPUS ADMINISTRATOR-RIZAL CAMPUS

PROJECT TITLE:

**CONSTRUCTION OF
PERIMETER FENCING AT RIZAL CAMPUS-
(MULBERRY FARM)**

Project Location: KSU-Rizal Campus, Bagbag, Rizal, Kalinga

RECOMMENDING APPROVAL:

Engr. LOPE T. BUEN, Ph.D
DIRECTOR FOR PLANNING AND STRATEGY

Address: Bulanao, Tabuk City, Kalinga

APPROVED BY:

EDUARDO T. BAGTANG, CPA, DBM
SUC PRESIDENT III

Address: Bulanao, Tabuk City, Kalinga

SHEET CONTENTS:

AS SHOWN

SHEET NUMBER:

PAGE NUMBER:

OWNERSHIP OF DOCUMENTS

RA 9266- SECTION 33
THESE DRAWINGS, AS INSTRUMENT
OF PROFESSIONAL
SERVICE IS A PROPERTY OF THE
ARCHITECT AND AS SUCH CANNOT
BE REPRODUCED, COPIED IN PART
OR IN WHOLE
WITHOUT PROPER AUTHORIZATION.